

Post Top One Way

Top Closure

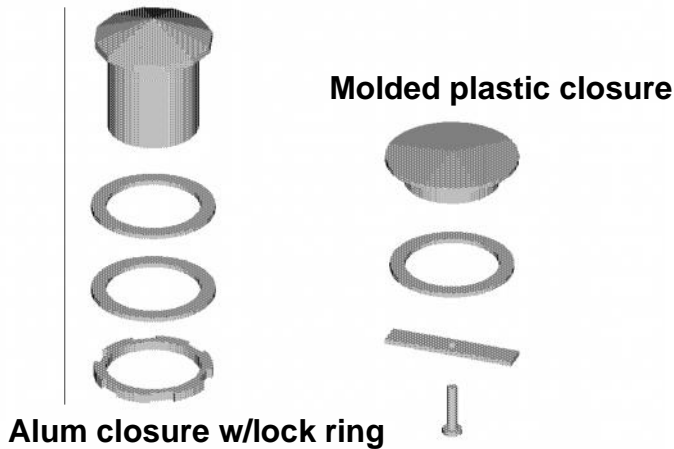

Alum closure w/lock ring

Molded plastic closure

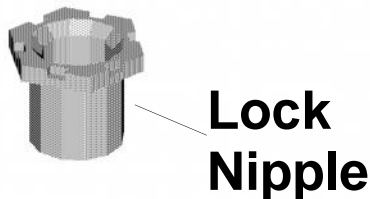

Lock Nipple

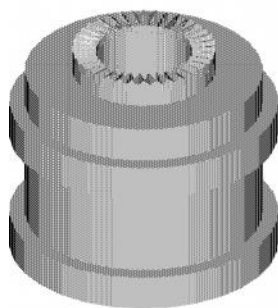

Threaded Hub

3/8" Leveling Screws

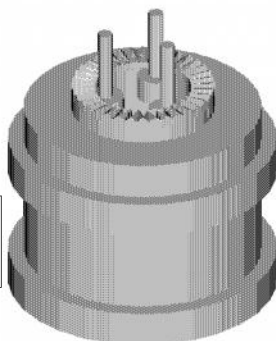

Tristud Hub

(For 3.5", 4.5" OD Poles)

1-800-345-6329

1. Color

Y=Yellow B=Gloss Blk F=Flat Blk
G=Dk Grn L=Light Grn Z=Bronze
X=Special N=None (natural finish)

2. Top Closure

1=Plastic 2=Alum N=None

3. Hub Material/Set Screws

# rows 3/8" set screws->	1	2
Iron	F	X
Alum	A	Y
Brass	B	Z

4. Hub Configuration

C=Center Mount, Threaded,
No Side Ports

P=Center Mount, Threaded,

4 Side ports w/plastic closures

A=Center Mount, Threaded,

4 Side ports w/alum closures

B=Center Mount, Threaded,

4 Side ports w/no closures

F=Offset Mount, Threaded,

No Side Ports

T=Center Mount, Tri-Stud,

No Side Ports (alum only)

2=Center Mount, Tri-Stud, 3.5" OD,

No Side Ports (alum only)

5. Lock Nipple (1 5/8")

F=Locknipple, Iron X=None

A=Locknipple, Alum

B=Locknipple, Brass

N=All Thread with Nut, Iron

T=Tristud, Pltd hardware

S=Tristud, SS hardware

POST1	-				-		
Option Category	1	2	3	4	5	6	

© Traffic Parts, Inc.

Traffic Signals (8"/12" PC/AL)

Four screw visor attachment
(threaded brass inserts on poly
doors)

"Tab" Visor

Self draining heavily
ribbed end sections
with integral shurlock

Captive wing nut
style door latch
assemblies

Backplate mounting
holes (4 per section)

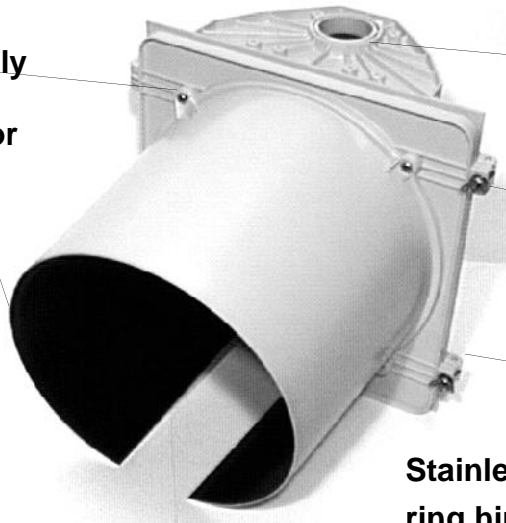

Stainless steel reflector
ring hinge pins

Door Gasket

One piece molded EPDM lens
gasket (Silicone available)

Alzak Reflector

Stainless Steel lens tabs;
(threaded brass inserts on
poly doors)



All external hard-
ware is stainless
steel

Reinforcing fins in poly head

Reflector Gasket

Fully insulated quick connect
socket wire terminals

Color coded socket wires

Rotatable high temperature
phenolic socket with lamp grip
and gasket

Aluminum reflector ring

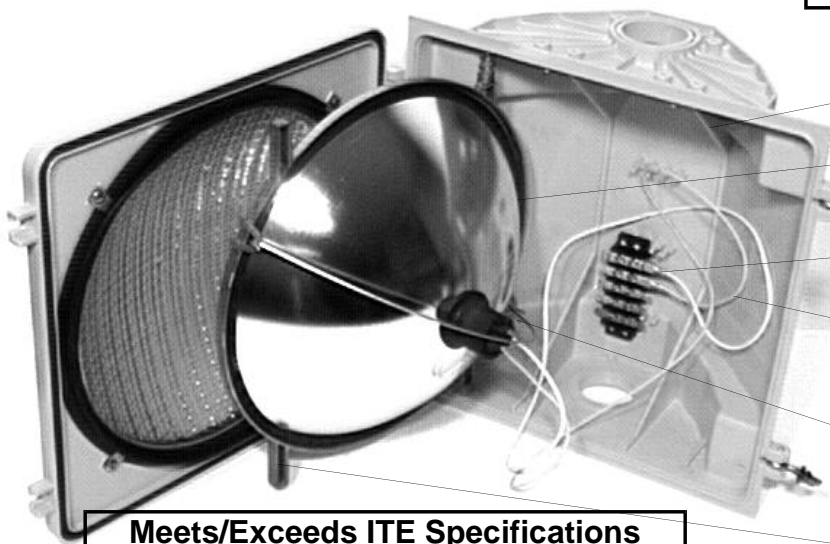

Meets/Exceeds ITE Specifications

Options:

Traffic Parts, Inc.

1. Size/Type

E=8" Vehicle T=12" Vehicle
 C=Combination Vehicle 8"/12"
 P=12" Pedestrian
 L=Lane Control (12" only)
 S=Speed Indicator (12" only)

2. Material

P=Poly A=Alum
 T=Top Section Al/Other PC
 (Vehicle Signals only)
 C=Poly Signal/Alum Visor

3. Color

Y=Yell B=Blk F=Flt Blk
 G=Dk Grn X=Special
 C=Yellow Body, Blk Door, Blk Visor
 D=Yellow Body, Blk Door, Yell Visor
 E=Yellow Body/Door, Black Visor
 V=Blk Body, Yellow Door, Blk Visor



4-5. Configuration

2 digit MPH for speed indicator
 2 digit configuration code for others

6. Terminal Block Type

5=5 position, 20a
 6=6 position, 20a (12" only)
 7=5 position, 30a
 8=6 position, 30a (12" only)
 2=2 position, 20a N=None

7. Terminal Block Location

T=Top C=Center B=Bottom
 X=Special

8. Visor

T=Tunnel C=Cap
 F=Full Circle N=No visor

9. Lens

N=None, w/1" lens clips

Option # →	P	S	G	M	D
Material: PC	X	X			
Glass			X	X	X
12" Arrows: Stenciled	X		X		
Molded				X	
Shields		X			X
8" Arrows: Stenciled	X	X	X		
Molded				X	X

10. Lamp Configuration

E=Incand/LED rdy, no gaskets
 Z=Incand/LED rdy, w/gaskets
 F=Incand w/fork terminals

11. Orientation

V=Vertical H=Horizontal

12. Support Plates

N=None 1=One top 2=One bottom
 3=Two in bottom 5=Two for elev plumb
 4=One in top section + one in bott section
 6=Doghouse (top/bottom of red)

13. Mechanical

0=Pltd Tri-stud kits 1=SS Tri-stud kits
 2=Plated screws 3=SS screws

14. LED Configuration

0=Not applicable

LED in:	LED incl	LED ready
All sections, 120vac	A	N
All sections, 12vdc	B	N
Red balls, Hand only	J	K
Red, Grn balls	L	M
Red, Grn balls/arrow	G	H
Grn balls/grn arrow	P	Q

1=Bimodal arrows (LED rdy arrows)
 S=Strobe, 12", 1 section

SIG	-	-	-	-	-	-	-	-	-	-	-	-	-	-	-	-	-	-	
Option Category →	1	2	3	4	5	6	7	8	9	10	11	12	13	14	15	16	17	18	19

Face Configuration Codes

8" or 12" Face

10	11	12													
13	14	15	20	21	22	23	24	25	27	28	3A	30	33	43	
16															
34	36	37	38	39	40	41	42	4A	44	45	46	47	48	49	4C
4B	4D	50	52	53	54	55	56	57	58	59	30	31	34	32	33

Count down

Combination of 8" & 12" Face

20	21	22	30	32	33	34	35	36	37	38	39
40	41	42	43	44	45	46	47	48	49	54	56
50	51	52	53	55	57	58	59				

Lane Control

10	11	12	20
30			

TRAFFIC PARTS INC.

P.O. BOX 837
 SPRING, TX 77383-0837

800-345-6329

SALES@TRAFFICPARTS.COM
WWW.TRAFFICPARTS.COM

PANEL MOUNT FLASHERS

SPECIFICATIONS	TP# 1039 (25DF) 2 circuit	TP# 6112 (12DC10DF) 2 circuit
Operating Voltage	60-135 VAC	6-24 VDC
Load Current	25 Amps (w/adequate heat sinking @ 77°F)	10 Amps (w/adequate heat sinking @ 77°F)
Temperature Range	-30° F to 165° F	-30° F to 165° F
Flash Rate (per circuit)	56-1/4 flasher/minute standard (other rates are available upon request)	55 flasher/minute standard
Size	1-3/4" x 2-1/4"	1-3/4" x 2-1/4"
Mounting	Flat surface w/2 mounting holes (top/bottom)	Flat surface w/2 mounting holes (top/bottom)



TP# 6112
 Pictured



TP# 2935
 Pictured

MUSHROOM FLASHERS

SPECIFICATIONS	TP# 2935 2 circuit (yellow)	TP# 5810 2 circuit (green)	TP# 1940 2 circuit (black)
Operating Voltage	95-135 VAC	95-135 VAC	95-135 VAC
Load Current	3 Amps	3 Amps	3 Amps
Temperature Range	-30° F to 165° F	-30° F to 165° F	-30° F to 165° F
Flash Rate	56-1/4 flashes /minute	56-1/4 flashes /minute	56-1/4 flashes /minute
Size	1-7/8" Overall Height	1-7/8" Overall Height	1-7/8" Overall Height
Mounting	Dual purpose mounting in top or bottom of signal and seals off opening	Dual purpose mounting in top or bottom of signal and seals off opening	Dual purpose mounting in top or bottom of signal and seals off opening